

LEGEND:

- 1.ENTRANCE GATE

2.PARKING

3.GAURD ROOM

4.PATHWAY

5.PLANTER BOX

6.GREEN SPACES

7. FLOATING SOIL MOUND

8.STEPPIING STONE

9.MAZE

10.GARDEN ARCH
11. SCULPTURE PLATFORM

12.BRIDGE

13.RESTAURANT

14.OPEN GYM

15.CHILDREN PLAY AREA

16.SOIL MOUND

17.SQUARE PAVILION

18.FOUNTAIN

19.POND

20.STEPPIED FOUNTAIN
- 21.FLOWER BED

22.SITTING

23.PERGOLA

24.OCTAGONAL GAZEBO

25.PEBBLE BED

26.TOILET

27.HEDGE

28.EXISTING BUILDING

29.EXISTING TREE

30.PARTERRE GARDEN

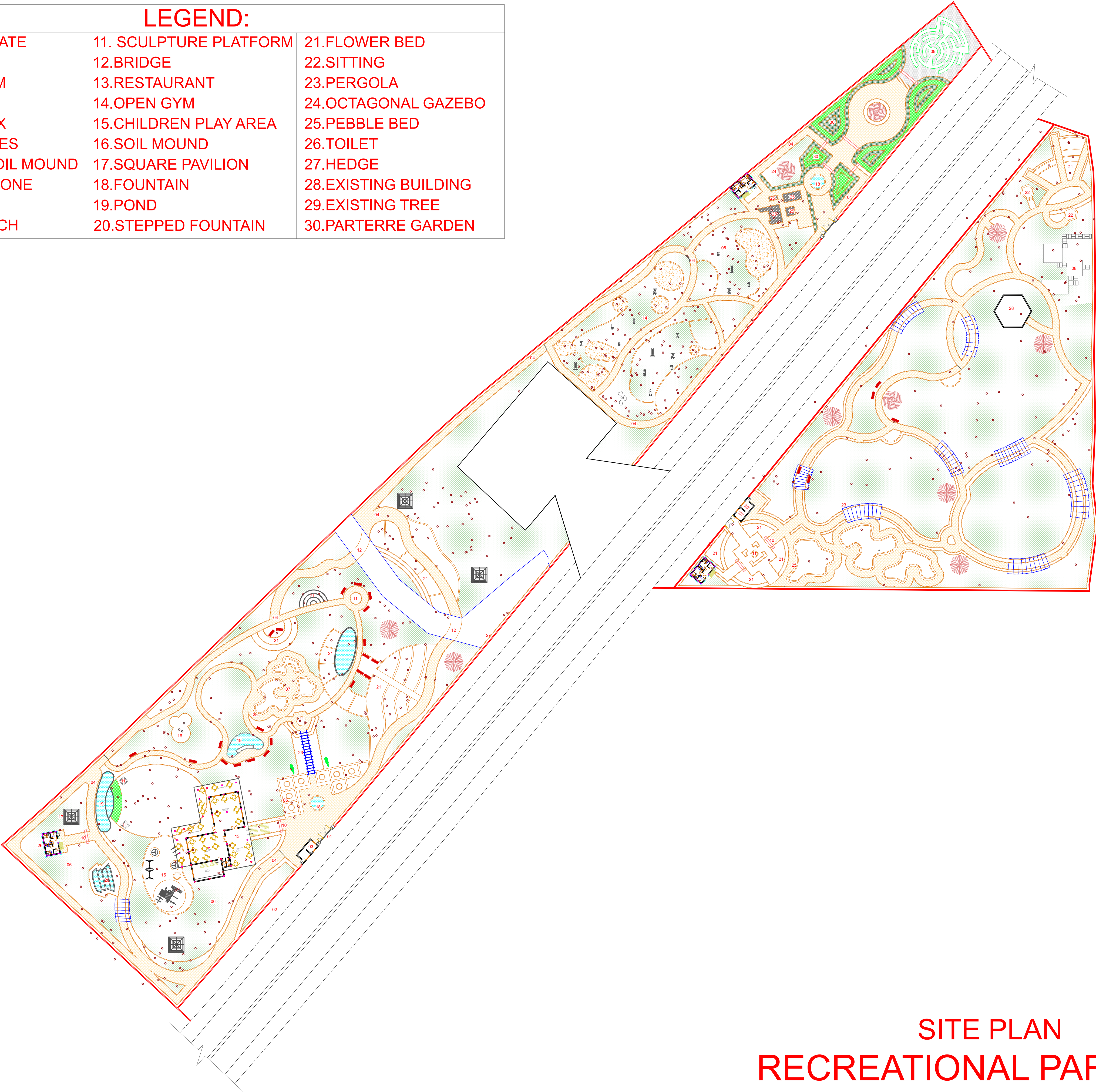

- NOTES
1. Read this drawing along with architectural & structural drawings.
  2. Do not scale, follow written dimensions only. All dimension are in \_\_\_\_\_ unless otherwise noted.
  3. For any ambiguity,discrepancy, deficient provision (if any felt necessary) etc must be brought to the notice of consultant/design office for clarification and work must be carried out after obtaining approval from competent authority.

- BRIEF SPECIFICATIONS
1. Brick work in foundation & superstructure.
  2. First class brick work in cement mortar (1:6)
  3. D.P.C. in cement concrete (1:2:4).
  4. Floor----- (a) Tile flooring.
  5. Roof----- 100mm thk. r.c.c. roof (1:2:4)
  6. Lintel band at 2100mm lvl.- 150mm thk. r.c.c. lintel (1:2:4)
  7. Stairs - rise= 150mm, tread= 300mm
  8. Sal wood frame & Plyboard 32mm thick flush door
  9. Aluminium glazed window and ventilators with guard bars shall be used.
  10. All masonry surfaces shall be plastered with cement mortar 1:8 with cement mortar 1:6 in roof
  11. All steel and wood work shall be painted with synthetic pant .
  12. All sanitary and electrical fittings shall be of standard and commercial quality .

Revisions		Revisions if any-
S.no	Date	Remarks
01.	06.03.2024	Concept plan
02.	07.01.2025	Revision-1
03.		Revision-2
04.		Revision-3
05.		Revision-4
06.		Revision-5
07.		Revision-6

DEVELOPED AREA

- =RECREATIONAL A- 5.59  
=RECREATIONAL B- 2.97

Sheet Title  
ARCHITECTURAL DRAWINGS

Drawing	Sheet No	Sheet size
AR	AR-01	A1

Project - SMART CITY MISSION  
(Open Spaces and Park Development)

Client - JUIDCO

Consultant -  
**Si+So Architects**  
608, 6th floor - Panchwati Plaza, Kutchery Road,  
Ranchi | Ph- +91 896 997 8304, +91 930 484 7503

Date	North	Checked by-
07-01-2025		Gautam
Drawn by-		Approved by- Architect-
Ankita kumari		Gautam Kr. Modi

SITE PLAN  
RECREATIONAL PARK 1 & 2